

# USE AND MAINTENANCE MANUAL

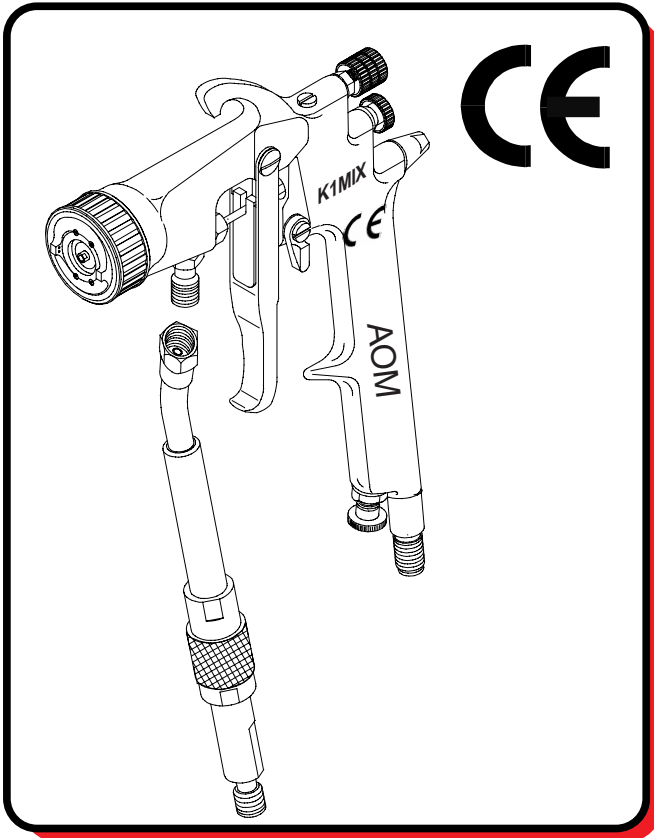

WRITTEN BY REDIMEC Snc  
SETTIMO MILANESE (MI)



GUN MOD. **K1 MIX**

(Rev. Ø - 20/02/00)  
GB - K1M - 1.0

ASTURO ORIGINALI MAVES Spa  
Via F.lli Bandiera, 7  
20090 Trezzano sul Naviglio (MI) ITALY

**SINCERT**



ISO 9001  
Cert. -04985-99-AQ-MIL-SINCERT

DICHIARAZIONE DI CONFORMITÀ / DECLARATION OF CONFORMITY  
KONFORMITÄTERKLÄRUNG / DECLARATION DE CONFORMITÉ  
DECLARACIÓN DE CONFORMIDAD



ASTURO ORIGINALI MAVES Spa  
Via Fli Bandiera, 7  
TREZZANO S/N MILANO - ITALIA  
++39 0248400326 - FAX ++39 0248402810  
P.IVA / VAT (registration number) 11164500156



**MODELLO / MODEL: K1 MIX**

**N\_ di MATRICOLA / SERIAL NUMBER**

**ANNO DI COSTRUZIONE / YEAR OF MANUFACTURE**  
**200**

**ACCESSORI IN DOTAZIONE / ACCESSORIES SUPPLIED**

**A.O.M** spa DICHIARA sotto la sua esclusiva responsabilità che la macchina a cui la presente dichiarazione si riferisce è conforme alle prescrizioni delle seguenti direttive:

**A.O.M** spa DECLARES on its own responsibility that the machine to which this declaration refers conforms with the requirements in the following directives:

DIRETTIVA **89/392/CEE** MODIFICATA DALLA DIRETTIVA **91/368/CEE**  
DALLA DIRETTIVA **93/44/CEE** E DALLA DIRETTIVA **93/68/CEE** (DIRETTIVA MACCHINE)  
DIRECTIVE **89/392/EEC** AMENDED BY DIRECTIVE **91/368/EEC**  
BY DIRECTIVE **93/44/EEC** AND BY DIRECTIVE **93/68/EEC** (MACHINE DIRECTIVE)

La macchina è inoltre conforme alle seguenti norme / The machine also conforms with following standards:

**UNI EN 292/1** (november 1992) Sicurezza del macchinario, Concetti fondamentali, principi generali di progettazione.- Terminologia, metodologia di base  
Machine safety, Fundamental concepts, General design principles - Terminology, basic methodology.

**UNI EN 292/2** (november 1992) Sicurezza del macchinario - Concetti fondamentali, principi generali di progettazione - Specifiche e principi tecnici  
Machine safety - Fundamental concepts. General design principles - Technical specification and principles.

**LUOGO / PLACE:**

TREZZANO S/N

**COGNOME - NOME / SURNAME - NAME:**

BRANCHINI RIZIERI

**POSIZIONE / POSITION:**

AMMINISTRATORE UNICO / SOLE DIRECTOR

**DATA / DATE:**

/ / /

**SIGNATURE:.....**

*Dear Customer,*

We want to thank you for choosing one of **ASTURO ORIGINALI MAVES Spa** products.

**ASTURO ORIGINALI MAVES Spa** is a leading reference point in the field of painting systems and machinery.

The name **ASTURO ORIGINALI MAVES Spa** has always meant reliability and safety and this is supported by over 70 years of experience and by our Customer satisfaction.

All our components have been designed and manufactured to guarantee the best performance ever.

To maintain the high quality level and lengthy reliability of our products throughout the years, always use original spare parts.

**ASTURO ORIGINALI MAVES Spa** units have the CERTIFICATION in accordance with EUROPEAN DIRECTIVE **89/392** (Machine Directive.)

We are certain we have met all safety requirements and we feel confident we have further improved working standards.

Our units, in fact, have the identification plate in accordance with  rulings. Furthermore, they are delivered with the instruction manual and the certificate with the Declaration of Conformity to European Directive 89/392 and to its various amendments.

*The Management*

## GENERAL CONTENTS

HOW TO USE THE MANUAL.....	1
SYMBOLS USED.....	1
INFORMATION LETTER.....	2
.	.
1.1 PACKAGING.....	3
2.1 IDENTIFICATION DATA.....	3
2.2 MACHINE DESCRIPTION.....	4
2.3 TECHNICAL FEATURES.....	5
2.4 STANDARD AND OPTIONAL COMPONENTS.....	5
2.5 MACHINABLE PRODUCTS.....	6
2.6 DIMENSIONS.....	6
3.1 INSPECTION OF PURCHASED PRODUCT.....	7
3.2 INSTALLATION CONDITIONS.....	7
3.3 HOW TO USE THE GUN.....	7
3.4 STRUCTURES TO BE ARRANGED.....	8
3.5 SAFETY PROCEDURES DURING USE.....	8
4.1 PRESSURE DISCHARGE PROCEDURES.....	9
4.2 ROUTINE MAINTENANCE.....	9
4.3 TROUBLESHOOTING.....	10
WARRANTY	
GUN ASSEMBLING DRAWINGS	

---

---

### HOW TO USE THE MANUAL

The following manual is a document that accompanies the machine throughout its lifetime. It is, therefore, an integral part of the machine. Carefully read the following warnings and procedures before engaging in any activity with this machine, including handling and unloading it from its transportation mean.

### SYMBOLS USED

All operations which might be dangerous if not performed correctly are indicated with the following symbol: 

All operations which, in order to avoid risks, must be performed by trained and authorized personnel are indicated by the following symbol: 

All personnel in charge of using the machine must be thoroughly trained; all the above information must be thoroughly understood and applied.

## INFORMATION LETTER

The following maintenance and instruction manual is an integral part of the machine and must always be available to the personnel in charge of using and maintaining it. The operator and the personnel in charge of handling the machine must have knowledge of the contents of the manual. The descriptions and illustrations in the manual are not to be considered as binding. Although the main features of the machine described in this manual are not subject to changes, **ASTURO ORIGINALI MAVES Spa** reserves the right to change those components, details and accessories it deems necessary to improve the machine or to meet manufacturing or commercial requirements, at any time and without updating this manual immediately.



**ALL RIGHTS ARE RESERVED.** The reproduction of any part of this manual, in any given form, without prior written authorization from **ASTURO ORIGINALI MAVES Spa**, is strictly forbidden. The content of this manual can be modified without prior notice. Great care has been taken in collecting and checking the documentation contained in this manual in order to make it as complete and comprehensible as possible. **ASTURO ORIGINALI MAVES Spa** machines are not designed to function in areas at risk of fires. For problems or information call **ASTURO ORIGINALI MAVES Spa** customer care technical service or your local dealer.

### CUSTOMER CARE TECHNICAL SERVICE

#### ASTURO ORIGINALI MAVES Spa

Via F.lli Bandiera, 7

20090 Trezzano Sul Naviglio (MI) ITALY

TEL. +39 0248400326 - 0248402802 (6 lines R.A.)

FAX. ++39 0248402810

SITE: <http://space.tin.it/economia/rizierib>

E-MAIL: [aomspa@tin.it](mailto:aomspa@tin.it)



The machine original configuration must not be modified in any way.  
On receiving the machine make sure that:

- ☞ The packaging is intact and undamaged.
- ☞ The supply corresponds to what has been ordered.
- ☞ In case of damage please call **ASTURO ORIGINALI MAVES Spa**

## 1.1 PACKAGING

To transport the K1 MIX gun, the unit is packaged in a cardboard box. All optional components are placed with the gun inside the same box. When transporting and storing the machine make sure the surrounding temperature remains included between -15 and 40 °C (5°F and 104°F). If transportation or storage operations last no longer than 24 hours do not exceed 50°C (122°F), otherwise the unit could be damaged.

If the need arises to store the machine, make sure the humidity values in the storage area remain included between 30 and 80%.

## 2.1 IDENTIFICATION DATA

The device has on one of its sides the manufacturer identification and CE RULING n° 89/392 conformity identification, as shown below.

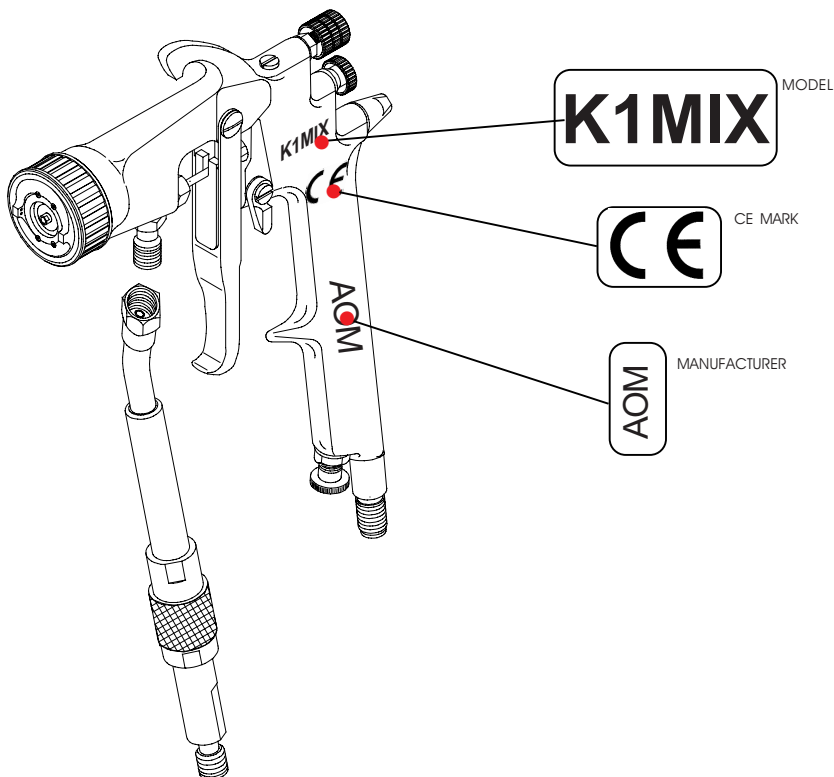

## 2.2 MACHINE DESCRIPTION

The K1 MIX gun is used to spray paints. It is possible to obtain smooth and even surfaces with this gun thanks to its micro-spraying system and reduced overspray. Its main features are lightness (600 g/21 oz.) and easy use. The K1 MIX offers the possibility of adjusting the spray pattern in order to obtain a high quality finishing. The K1 MIX gun, coupled with a pneumatic pump unit, type mixed air, model K15 ASTURO, guarantees high transfer efficiency (over 80%) and saves considerable amounts of paint. The drawing below indicates the most important features of the gun.

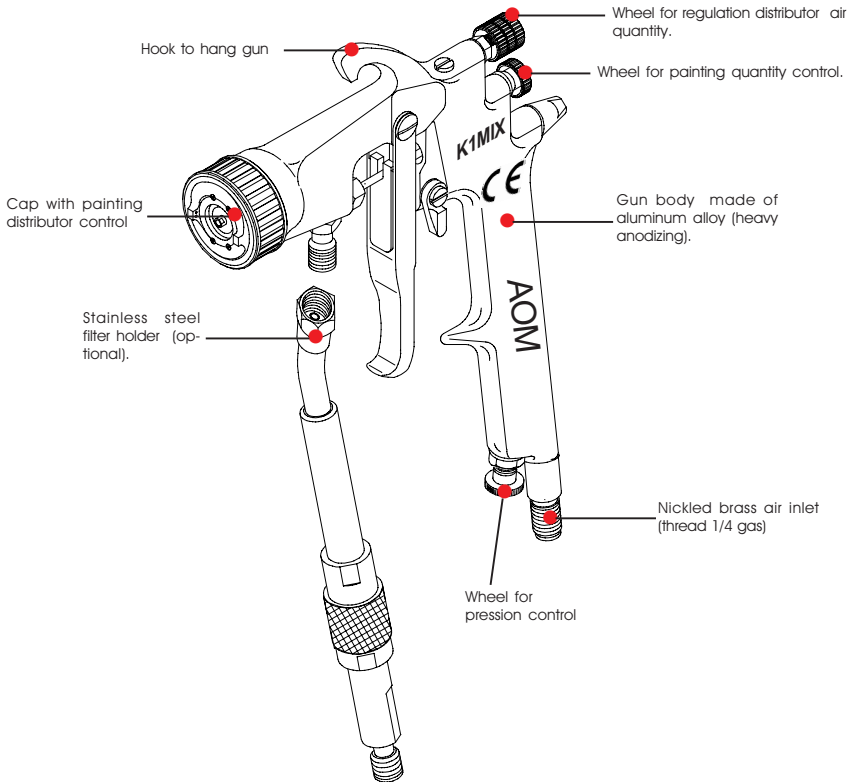

## 2.3 TECHNICAL FEATURES

The spray gun must be coupled with a pump with a maximum fluid pressure of 250 bar (3570 psi). **ASTURO ORIGINALI MAVES Spa** carries out all the necessary tests on the paint unit before delivering it to its customers.

### NOZZLE AND GUN TECHNICAL FEATURES TABLE

NOZZLE	SPRAY ANGLE	30Cm SPRAY OPENING	ORIFICE mm	ORIFICE IN INCH	PRODUCTS	FILTER
7x20	20°	13.5	0.15	0.007"	CLEAR AND PIGMENTED LACQUER, ENAMELS	RED 200M
7x40	40°	16.5				
9x20	20°	14				
9x40	40°	17.5	0.23			
9x60	60°	22.5				
11x10	10°	9	0.28	0.011"	NITRE, SYNTHETIC AND POLYURETHANE PAINTS	YELLOW 100 M
11x20	20°	14.5				
11x40	40°	18.5				
13x20	20°	15.5				
13x40	40°	20	0.33	0.013"		
13x60	60°	26.5				
15x20	20°	16.5	0.38	0.015"	RUST PREVENTER PAINTS	WHITE 60 M
15x40	40°	21.5				
18x10	10°	12.5	0.46	0.018"	THIXOTROPIC, SPRAY STUCCOS, FILLED BASES, INORGANIC ZINC, VERY THICK PAINTS, PAINTS WITH GLUES, FILLERS	WHITE 60 M
18x20	20°	16.5				
18x40	40°	20.5				
18x60	60°	29.5				
21x10	10°	13.5	0.53	0.021"		
21x20	20°	18.5				
21x40	40°	21.5				
21x60	60°	32.5				

CHARACTERISTICS	VALUE
Air max. pressure	5 Bar/71.4 psi
Air working pressure	1-2.5 Bar/14.28-35.7 psi
Working prod. pressure	50 - 150 Bar/714-2142 ps
Product max. pressure	250 Bar/3570 psi
Nozzles (microrinches)	007-021
Weight	600 g/21 oz.
Air inlet	M 1/4"
Product inlet	M 1/4"

Nozzle maximum measure: 0.021"

The above technical features are only exemplifying and can vary without prior notice.

## 2.4 STANDARD AND OPTIONAL COMPONENTS

The machine is delivered with the following standard components:

- ☞ 1 - Dismantling wrench.
- ☞ 1 - Cleaning brush.
- ☞ 1 - Use and maintenance manual.
- ☞ 1 - Declaration of conformity to CE RULINGS.
- ☞ 1 - Warranty certificate.
- ☞ 1 - Spring for pressure.
- ☞ 2 - Spare set for stuffing box.

### On request:

- ☞ MIX nozzles of various dimensions.
- ☞ Stainless steel filter holder with gun filter
- ☞ K 15 high pressure PUMP.
- ☞ Connection hoses.
- ☞ Cleaning needles.
- ☞ Paint filters 60, 100, 200 MESH

## 2.5 MACHINABLE PRODUCTS

The K 1 MIX guns are designed to paint on iron, wood and plastic material. The materials which can be used in the gun are: synthetic paints and enamels, polyutherane, nitre, enamels, varnishes, water based paint, lacquers and primers. The manufacturer must authorize the use of the unit with other products and consequently the unit technical features must be changed in order to function properly with the alternative materials. **ASTURO ORIGINALI MAVES Spa** is relieved of all responsibility in case of accidents resulting from the use of the machine by UNAUTHORIZED and unqualified personnel or by personnel using the machine differently than intended.

**DO NOT USE THE PAINTING SYSTEM WITH  
FLAMMABLE OR HIGHLY TOXIC PRODUCTS  
SUCH AS GASOLINE, HERBICIDE AND PESTICIDE**

## 2.6 DIMENSIONS

The gun has the following dimensions:

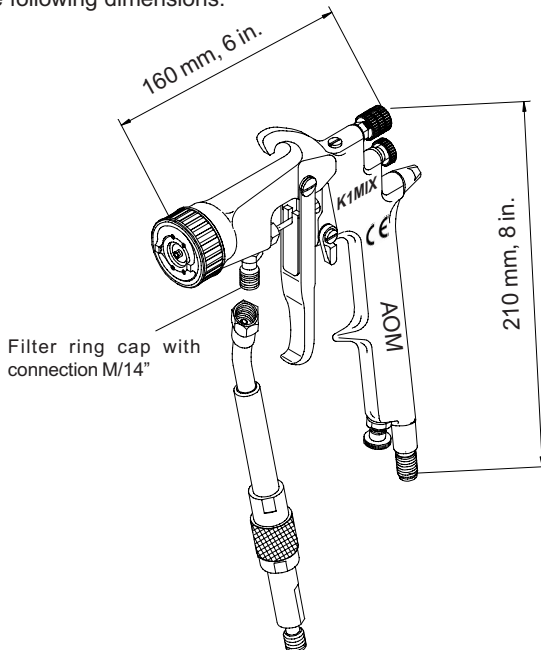

## 3.1 INSPECTION OF PURCHASED PRODUCT

Inspect the equipment before its use to check for damages caused by transportation or improper storage. Make also sure that all standard and optional components have been delivered.

## 3.2 INSTALLATION CONDITIONS

The gun must be fed with a maximum fluid pressure of 250 bar (3570 psi). It is advisable to use dry compressed air to obtain the best painting results. To mount the double hose (air/product) proceed as follows (use the drawing below):

- ☞ Fasten the air inlet hose (BLUE hose) to the gun (A).
- ☞ Fasten the paint inlet hose (LIGHT BLUE hose) to the gun (B).
- ☞ Choose which nozzles and spray gun filter better adapt to the operation which must be performed.

### WARNING

On one side of the pump cart (K15) there is a unit formed by two filters with pressure regulators. Finding the M1/4" air outlet connector (which must be connected to the gun air inlet "A") is fairly simple because there are only two connectors for the air connection; the other one is the pump air inlet.

### WARNING

Always use high pressure hoses to carry out all connections. Before using the equipment, make sure the connections and hoses are in perfect working conditions, that is without holes, bends or splits.

## 3.3 HOW TO USE THE GUN

- ☞ Regulate the spraying angle (distributor) with the wheel (1) (by opening the wheel, you will open the spraying angle).
- ☞ Regulate spraying distributor position by turning the cap (3), see drawing below.
- ☞ Gradually open the fluid passage by turning the wheel (2) until the desired quantity is obtained. Check the regulation on a smooth trial surface until the desired result is obtained.
- ☞ Regulate inlet air pressure by means of the wheel (4).

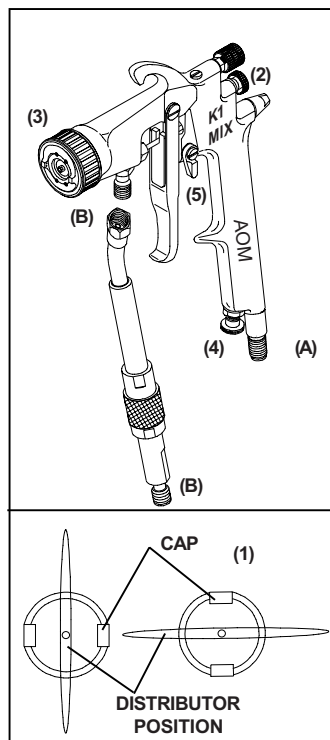

## 3.4 STRUCTURES TO BE ARRANGED









Painting operations **MUST** be possibly carried out in an appropriate spray booth equipped with a filtering system. Do not use the gun if the filtering system is not activated. Always wear protection gloves, glasses, breathing filters with active carbon and adequate clothing for the protection of the entire body.

## 3.5 SAFETY PROCEDURES DURING USE

**TO USE** the painting unit **STRICTLY OBSERVE** the following precautions and safety criteria, which follows.

**ASTURO ORIGINALI MAVES Spa** declines every responsibility whatsoever in case the user does not observe said precautions and safety criteria; furthermore, it is not responsible for any kind of negligence when using the equipment.

### WARNING

-  Always wear protective gloves, masks, breathing filters with activated carbon and adequate clothing for the protection of the entire body.
-  The gun is employed with paints and thinners which are highly inflammable, therefore, use the gun in well ventilated areas and avoid any action which might start a fire (eg. smoking, high temperature slags or shavings, sparks or whatever electric risks).
-  CHECK the chemical compatibility of the products on their technical safety charts. Further information on the materials which make up the gun are available, on request, at **ASTURO ORIGINALI MAVES Spa**.
-  The use of products which contain organic solvents might cause intoxication because of the created toxic vapours.
-  DO NOT USE the unit with food or medicines.
-  DO NOT EXCEED the indicated maximum working pressure (see section 2 or 3).
-  BEFORE starting on any dismantling, cleaning, maintenance or assembly operation DISCHARGE the pressure in the hoses (see section 4.1).
-  Never direct the gun towards human body or animals.

### IMPORTANT

**DO NOT USE** the unit with **HALOGENATED HYDROCARBON** thinners (eg. Ethylchloride, Trichloride, etc.) which might explode when coming into contact with aluminum or galvanized parts.

## 4.1 PRESSURE DISCHARGE PROCEDURES

When stopping the system to carry out operations on the unit or when stopping it at the end of the working day, the high pressure inside the unit must be completely discharged. When the main air inlet is shut off, the air is automatically discharged from the pump motor.

**WARNING** 

**The product in the flexible tube is still under pressure.**

PROCEED AS FOLLOWS:

- 1 Lock spray gun lever with the safety trigger lock (5) (see pag. 7).
- 2 Shut off the air supply to the equipment.
- 3 Unlock the lever safety bolt.
- 4 Take a metal bucket, make sure it is firmly fixed on the ground and keep the spray gun pressed tightly against the walls of the bucket. Pull lever to discharge the product.

## 4.2 ROUTINE MAINTENANCE

The routine maintenance of the K1 MIX gun is simple and does not require special operations because its components do not need to be lubricated. Clean the gun daily or at the end of each working session so that product residue will not dry out on its walls, thus guaranteeing long term efficiency.

### **CLEANING:**

Unscrew the cap clamping ring, remove the micro-nozzle and, with the provided wrench, dismantle the nozzle. Place everything in the thinner. Carefully clean the micro-nozzle, dip it in thinner to dissolve residue inside it. Blow compressed air through it from the front to eliminate all traces of material. The nozzle must be daily mounted back on with its packing. Clean the head of the gun and the tip of the nozzle with the provided brush; at least once a week dismantle and clean the product needle too. Reassemble the gun, lubricate with a thin layer of oil the threads, and close tightly.

**DO NOT USE POINTED METAL OBJECTS TO CLEAN CLOGGED PASSAGE HOLES. THESE OPERATIONS WOULD DAMAGE THEM, REDUCING THE SPRAYING QUALITY.**

Clean the body of the pump with a cloth soaked in thinner. In case industrial washers are used to clean the gun, close the fan adjustment and the needle adjustment tightly by turning them clockwise in order to avoid thinner infiltrations which might damage packings in the long run. Once in a while, lubricate the threaded parts such as the cap clamping ring, the needle adjustment and the air valve cap (including the dip rod) with a thin layer of synthetic oil, in order to avoid seizing up caused by the effect of thinners on the gun components.

**THE LUBRICANTS USED MUST NOT CONTAIN SILICONE.**

**WARNING** 

**IF THE NEED ARISES CALL THE ASTURO ORIGINALI MAVES Spa CUSTOMER CARE SERVICE.**

## 4.3 TROUBLESHOOTING

The chapter describes how to solve the most common problems which could affect the unit.

The problem is indicated by the following symbol: (✘)

The possible cause is indicated by the following symbol: (⇒)

The possible solution is indicated by the following symbol: (●)

### ✘ THE GUN SPRAYS INTERMITTENTLY ?

- ⇒ Spray nozzle is loose.
- ⇒ Worn needle packing.
- ⇒ Worn cone head packing.
- ⇒ Worn cone nozzle.
- Tighten the nozzle.
- Replace stuffing box set.
- Replace the packing.
- Replace the nozzle.

### ✘ UNEVEN JET ?

- ⇒ Worn or dirty cap air holes.
- ⇒ Worn or dirty micro-nozzle.
- Clean the gun components carefully.
- Replace damaged parts.

### ✘ PAINT LEAKS OUT OF THE STUFFING BOX?

- ⇒ Worn stuffing box packing.
- ⇒ Slow stuffing box nut.
- Replace stuffing box.
- Replace stuffing box nut.

### ✘ PAINT LEAKS OUT OF NOZZLE WITHOUT PULLING THE LEVER?

- ⇒ Ball and ball seat dirty of dry paint.
- ⇒ Worn ball and ball seat.
- ⇒ Slow nozzle tip.
- ⇒ Dirty nozzle tip cone.
- Clean the gun parts very carefully.
- Replace both the ball and seat.
- Tighten tip.
- Clean cone and tighten tip.

### ✘ AIR COMES OUT WHEN THE LEVER IS RELEASED?

- ⇒ The air valve rod does not slide.
- ⇒ Dirt inside the air valve body.
- ⇒ Air stuffing box nut too tight.
- Lightly lubricate gun components.
- Clean with care.
- Loosen stuffing box nut.

## WARRANTY

All **ASTURO ORIGINALI MAVES Spa** appliances are guaranteed for a period of 12 months from the date written on the invoice, unless otherwise stated in writing. The warranty covers all manufacturing faults and material defect. Replacements and repair operations are covered only if carried out by our company and at our servicing shops.

The faulty parts must be sent **CARRIAGE FREE**.

Once the components have been repaired they will be sent **CARRIAGE PAID** to the customer.

The warranty does not cover our company personnel aid during installation or dismantling operations. If for practical purposes one of our employee is sent to the premises, a charge will be made for the time plus extra for travelling and expenses.

Our warranty does not cover direct or indirect damage, to people or property, caused by our appliances and it does not cover repair operations carried out by the owner or by a third party.

The following are not covered by our warranty:

- ☞ failure caused by incorrect use or assembly.
- ☞ failure caused by external agents.
- ☞ failure caused by lack of maintenance or negligence.

### WARRANTY FORFEITURE:

If the form attached below is not filled out and returned.

In case of delayed payment or other contract defaults.

All repair operations carried out under warranty do not interrupt its duration.

Whenever changes or repairs are carried out on our machinery without prior authorization

Whenever the unit seems tampered with, dismantled or previously repaired in unauthorized servicing shops.

Whenever the serial number is damaged or removed.

When the damage is caused by improper use or functioning, or if the machine falls, is bumped or by other causes of malfunctioning not due to normal working conditions

**All disputes will be settled in the court of justice of Milan (Italy).**



NAME: \_\_\_\_\_  
COMPANY: \_\_\_\_\_  
ADDRESS: \_\_\_\_\_  
V.A.T. NUMBER \_\_\_\_\_  
UNIT MODEL: \_\_\_\_\_  
SERIAL NUMBER: \_\_\_\_\_  
DATE: \_\_\_\_\_  
STAMP AND SIGNATURE: \_\_\_\_\_

**Send this form fully completed (capital letters) to:**

**ASTURO ORIGINALI MAVES Spa**

Via F.lli Bandiera, 7

20090 Trezzano sul Naviglio (MI) ITALY

# USE AND MAINTENANCE MANUAL



## GUN ASSEMBLING DRAWINGS

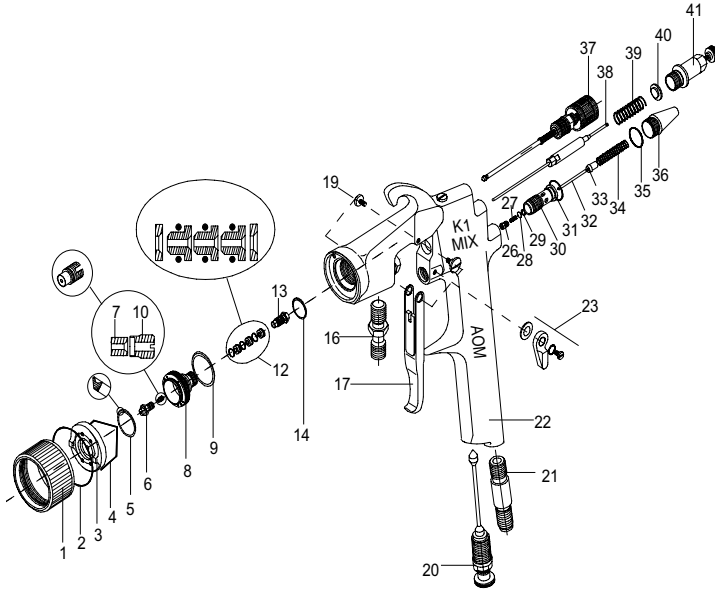

# USE AND MAINTENANCE MANUAL



## GUN COMPONENTS

Pos.	CODE	Description
1	25520R	CAP CLAMPING RING K1MIX
2	24007R	FRICTION RING PTFE
3	25521R	CAP K1MIX COMPLETE
4	25523R	V SPRING FOR CAP
5	25547R	CAP AIR SEP. PACKING MIX T.N.
6	25611R	NOOZLE TIP MIX T.NEW
7	25613R	BALL SEAT MIX T.NEW
8	25612R	BODY NOOZLE HOLDER MIX T.NEW
9	24013R	PTFE PACKING FOR NOOZLE NEBULIZ.
10	25553R	BALL SEAT HOLDER LEG.MIX T.NEW
12	25630R	STUFFING BOX SET LEG.MIX T.N.COMPL.
13	25635R	STUFFING BOX NUT MIX T.NEW
14	24017R	HEAD CONE PACKING
16	24073R	NIPPLES INLET PRODUCT 1/4"
17	25570R	COMPL. CONTROL LEVER LEG. MIX T.V.
19	16591A	SCREW LEVER PIN
20	24084R	NEW PRESS. ADJUSTER COMPL. LEG.MET.
21	24081R	INLET AIR NIPPLES 1/4" NICH.
22	25514R	BODY LEGEND MIX T.N.COMPLETE
23	25660R	SECURITY FOR MIX T.N.COMPLETE
26	24062R	AIR STUFFING BOX NICHEL. NUT
27	24056R	SPRING NEEDLE STUFFING BOX
28	24058R	FLAT RING 3X7X0.5 ZINC.
29	24060R	STUFFING BOX NEEDLE AIR VALVE/NEEDLE
30	24050R	AIR VALVE BODY
31	24052R	O RING 3030 GREEN VITRON SH.70
32	16531A	BAR OPENING AIR VALVE BRI USA
33	16575A	PAWL AIR VALVE BRI/BBS/K1/KS
34	24047R	AIR VALVE SPRING
35	24045R	O RING 2037 GREEN VITRON SH. 70
36	25642R	AIR VALVE PLUG MIX T.N. NEUTRAL
37	25640R	JET ADJUSTER MIX T.N.COMPL.NEUTRAL
38	25620R	NEEDLE ADJ. PASS. PROD. MIX T.N.COMPL.
39	25643R	SPRING PULLING NEEDLE MIX T.N.200 BAR
39A	25644R	SPRING PULLING NEEDLE MIX T.N. 250 BAR
40	25655R	BASE FOR SPRING MIX T.NEW
41	25650R	COMPLETE THRUST HOLDER MIX T.N.
42	25637R	WRENCH LEG.MIX-T.N. TRI.-A TREATED
43	24097R	NYLON BRUSH MM.12X40X125

**KIT PACKINGS AND SPRINGS (25590R) ( 2-4-5-9-14-27-28-29-32-33-34-35-39-40)**

**KIT NEEDLE NOOZLE CAP ( 25508) ( 2-3-4-5-6-7-10-38)**

# USE AND MAINTENANCE MANUAL



## FILTER HOLDER DRAWING

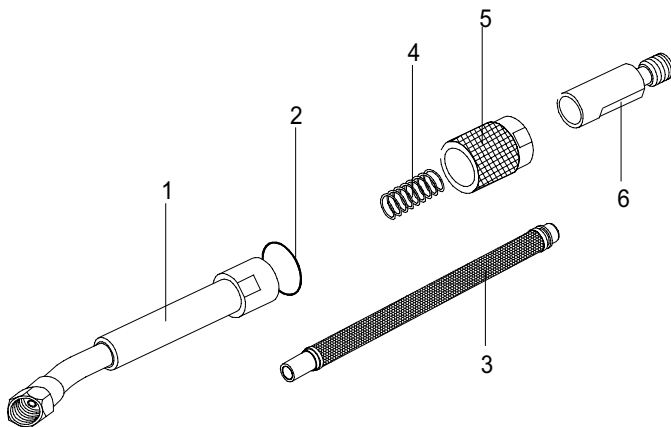

### STAINLESS STEEL FILTER HOLDER WITH FILTER

POS.	CODE		
1	302010R		Complete filter holder connection
2	24017R		Packing
3/1	303030	(30 MESH)	Rifle-butt gun filter
3/2	303050	(50 MESH)	Rifle-butt gun filter
3/3	303100	(100 MESH)	Rifle-butt gun filter
3/4	303200	(200 MESH)	Rifle-butt gun filter
4	301500		Filter supporting spring
5	25567R		Lower connector lock bush
6/1	25562R	(M - 1/4" BSP)	Lower connector
6/2	25568R	(M - 3/8" BSP)	Lower connector
6/3	25562R	(M - 1/2" JIC)	Lower connector
6/4	25566R	(M - M 16 x 1.5)	Lower connector

COD. 302014	F 1/4" - M 1/4" (30 M)	COD. 302038	F 1/4" - M3/8" (30M)
COD. 302024	F 1/4" - M 1/4" (50 M)	COD. 302048	F 1/4" - M3/8" (50M)
COD. 302034	F 1/4" - M 1/4" (100M)	COD. 302058	F 1/4" - M3/8" (100M)
COD. 302044	F 1/4" - M 1/4" (200M)	COD. 302068	F 1/4" - M3/8" (200M)
COD. 302016	F 1/4" - M 16 x 1.5 (30M)	COD. 302012	F 1/4" - M1/2 JIC (30M)
COD. 302026	F 1/4" - M 16 x 1.5 (50M)	COD. 302022	F 1/4" - M1/2 JIC (50M)
COD. 302036	F 1/4" - M 16 x 1,5 (100M)	COD. 302032	F 1/4" - M1/2 JIC (100M)
COD. 302046	F 1/4" - M 16 x 1.5 (200M)	COD. 302042	F 1/4" - M1/2 JIC (200M)